

TECHNICAL DATA SHEET - STANDARD TOOTH

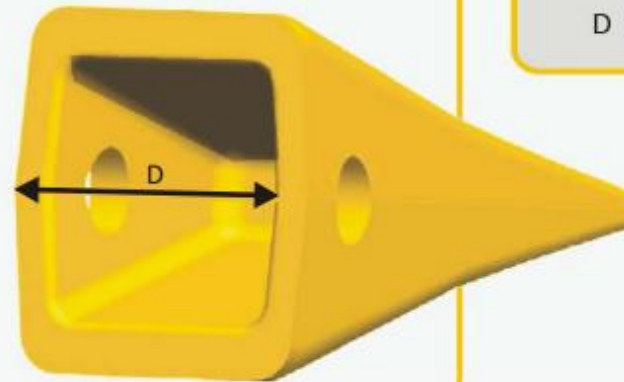
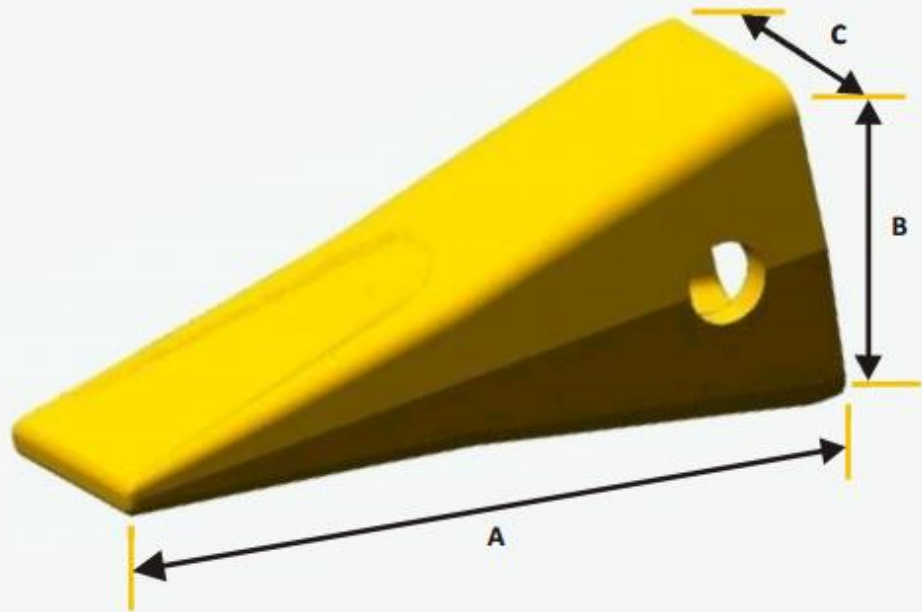

Label	Dimensions
A	270 mm
B	122 mm
C	117 mm
D	101.6 mm

NOTES:

CAST STEEL BUCKET TOOTH

IMPORTANT- PLEASE ENSURE YOU CHECK YOUR DIMENSIONS CAREFULLY BEFORE ORDERING TO ENSURE THE CORRECT PARTS ARE SUPPLIED.

